

Green Pt Conductive Plastic Linear Sensor

<RoHS Compliance>

LP-F series

FEATURES

- Light Weight
- Low friction.

DIMENSION (mm)

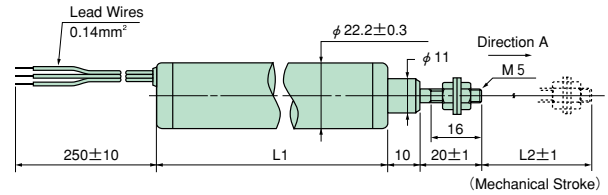

MOUNTING

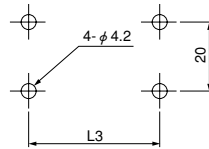

MTG Holes Spacing

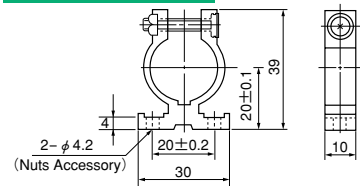

Housing Length · Mounting

Model No.	LP-100F-C	LP-150F-C	LP-200F-C	LP-250F-C	LP-300F-C
Housing Length(L1)	138±1mm	188±1mm	238±1mm	288±1mm	338±1mm
Mech. Stroke(L2)	103±1mm	153±1mm	203±1mm	253±1mm	303±1mm
MTG Holes Spacing(L3)	124mm	174mm	224mm	274mm	324mm

Electrical Specifications

Model No.	LP-100F-C	LP-150F-C	LP-200F-C	LP-250F-C	LP-300F-C
Electrical Stroke	100mm±0.5mm	150mm±0.5mm	200mm±1mm	250mm±1mm	300mm±1mm
Total Resistance	1, 2, 5, 10kΩ	1, 2, 5, 10kΩ	1, 2, 5, 10kΩ	2, 5, 10kΩ	2, 5, 10kΩ
Total Resistance Tolerance	±20%				
Independent Linearity	±0.3%				
Power Rating	2W / 70°C	3W / 70°C	4W / 70°C	4W / 70°C	4W / 70°C
Output Smoothness	0.1% / MAX.				
Insulation Resistance	100MΩ MIN.DC500V				
Dielectric Strength	AC500V 1 Minute				
TC of Resistance	±400ppm / °C				

Mechanical Specifications

Friction	1N MAX.				
Weight	Approx. 110g	Approx. 140g	Approx. 170g	Approx. 200g	Approx. 230g

Environmental Specifications

Operating Temperature	-25~80°C
Vibration	100m / s ² 500Hz 3 axis 2hours each
Shock	500m / s ² 11ms 6 axis 3times
Life Cycle	5M Cycles MIN.

OPTIONS

- 2 sections
- Independent Linearity : ±0.1%

SCHEMATIC

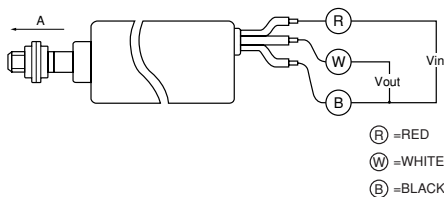

Red, White and Black indicate harness colors

OUTPUT CHARACTERISTICS

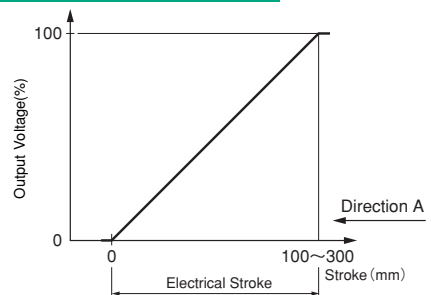

MOUNTING HARDWARE

- 4-M4 Nuts
- 2-M5 Nuts, 2-Lock Washers

Headquarter Switzerland:
Pewatron AG
Thurgauerstrasse 66
CH-8050 Zurich
Phone +41 44 877 35 00
info@pewatron.com

Office Germany:
Pewatron Deutschland GmbH
Edisonstraße 16
D-85716 Unterschleißheim
Phone +49 89 374 288 87 00
info.de@pewatron.com



PEWATRON
SENSORS · POWER SOLUTIONS

We are here for you. Addresses and Contacts.

Sales Germany & Austria

**Geometrical sensors
Other products**

Kurt Stritzelberger
Phone +49 89 374 288 87 22
kurt.stritzelberger@pewatron.com

**Pressure sensors
Other products**

Gerhard Vetter
Phone +49 89 374 288 87 26
gerhard.vetter@pewatron.com

Gas sensors and modules

Peter Felder
Phone +41 44 877 35 05
peter.felder@pewatron.com

Sales Switzerland & Liechtenstein

Postcode 3000 – 9999

Basil Frei
Phone +41 44 877 35 18
basil.frei@pewatron.com

Postcode 1000 – 2999

Christian Mohrenstecher
Phone +41 76 444 57 93
christian.mohrenstecher@pewatron.com

Sales International Key Accounts

Peter Felder
Phone +41 44 877 35 05
peter.felder@pewatron.com

Sales Other Countries / Product Management

**Pressure Sensors
Load Cells**

Philipp Kistler
Phone +41 44 877 35 03
philipp.kistler@pewatron.com

**Gas sensors
Gas sensor modules**

Dr. Thomas Clausen
Phone +41 44 877 35 13
thomas.clausen@pewatron.com

Flow / Level / Medical products

Dr. Adriano Pittarelli
Phone +49 89 374 288 87 67
adriano.pittarelli@pewatron.com

Power supplies

Sebastiano Leggio
Phone +41 44 877 35 06
sebastiano.leggio@pewatron.com

**Linear position sensors
Angle sensors**

Eric Letsch
Phone +41 44 877 35 14
eric.letsch@pewatron.com

Drive technology
CH Postcode 5000 – 9999 / DE

Roman Homa
Phone +41 76 444 00 86
roman.homa@pewatron.com

**Accelerometers
Sensor elements**

Christoph Kleye
Phone +49 89 374 288 87 61
christoph.kleye@pewatron.com

**Current sensors / Power solutions &
Turkey**

Osman Coban
Phone +49 89 374 288 87 65
osman.coban@pewatron.com

Drive technology
CH Postcode 1000 – 4999 / AT / IT / FR

Christian Mohrenstecher
Phone +41 76 444 57 93
christian.mohrenstecher@pewatron.com

Harald Thomas
Phone +49 89 374 288 87 23
harald.thomas@pewatron.com