

Characteristics

Unless otherwise specified, all parameters are measured at 25 °C and 60% RH

Preliminary

| Parameters | Min | Typ | Max | Unit |
|-------------------------------|------------------------------|------|-------|------|
| Excitation | 3 Vdc @ 5 mA (2.7 – 5.5 Vdc) | | | |
| Pressure range | -150 | | 150 | mbar |
| Zero Output (0 mbar) | 1.464 | 1.50 | 1.536 | V |
| Span Output (-/+150 mabr) | | 2.40 | | V |
| Accuracy(25°C) | | 0.5 | | %FS |
| Accuracy(0/50°C) ¹ | | 1.5 | | %FS |
| Accuracy(-5/55°C) | | 2.5 | | %FS |
| Linearity | -0.5 | | +0.5 | %FS |
| Thermal Hysteresis | -0.15 | | +0.15 | %FS |
| Temp - Compensating | 0 | | 50 | °C |
| Temp - Operating | -20 | | +80 | °C |
| Temp - Storage | -40 | | +125 | °C |
| Over Pressure | 3X | | | FS |
| Burst Pressure | 6X | | | FS |

NOTES:

1. Including NOL, hysteresis, TCS and TCO from 0 to 50 deg C, BFSL definition. 0.5%FS at 25 deg C.
2. Wetted material contains PA9T, silicon, Au, pyrex, epoxy & FR4
3. Zeroing after installation is recommended
4. Output is ratiometric to supply voltage
5. Power Supply Decoupling from Pin VDD to Pin VSS: 100 nF
6. Zeroing at installation

Dimension

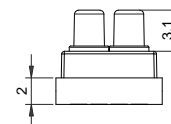
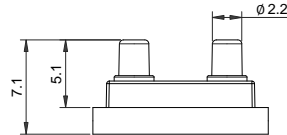
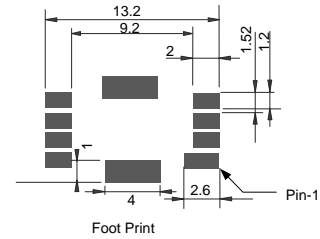
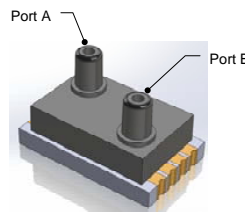
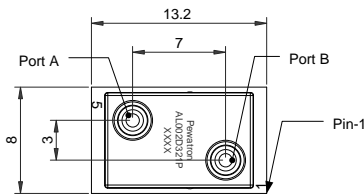

Ordering Information

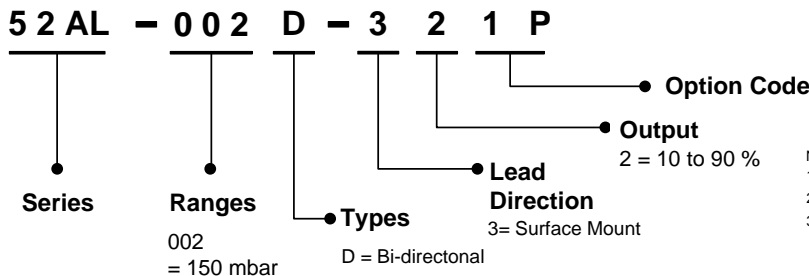

| Pin # | Description |
|-------|-------------|
| 1~4 | N.C |
| 5 | OUT |
| 6 | N.C. |
| 7 | VDD |
| 8 | GND |

- Notes:**
1. Port B is used for positive differential or gage
 2. All dimensions are mm
 3. Soldering of lead pins: 250 °C for 5 sec max.

SCD7-311-A001G
12-18 R0

Headquarter Switzerland:
Pewatron AG
Thurgauerstrasse 66
CH-8050 Zurich
Phone +41 44 877 35 00
info@pewatron.com

Office Germany:
Pewatron Deutschland GmbH
Edisonstraße 16
D-85716 Unterschleißheim
Phone +49 89 374 288 87-0
info.de@pewatron.com



PEWATRON
SENSORS · POWER SOLUTIONS

We are here for you. Addresses and Contacts.

Sales Germany & Austria

Postcode 00000 – 31999
Postcode 38000 – 39999
Postcode 80000 – 99999
Austria

Kurt Stritzelberger

Phone +49 89 260 52 80
Mobile +49 171 803 41 35

kurt.stritzelberger@pewatron.com

Postcode 32000 – 37999
Postcode 40000 – 79999

Gerhard Vetter

Phone +49 674 394 75 75
Mobile +49 163 762 74 30

gerhard.vetter@pewatron.com

Geometrical sensors
Sensor elements

Thorsten Ravagni

Phone +49 60 479 53 627

thorsten.ravagni@pewatron.com

Sales Switzerland & Liechtenstein

Postcode 3000 – 9999

Basil Frei

Phone +41 44 877 35 18
Mobile +41 76 279 37 26

basil.frei@pewatron.com

Postcode 1000 – 2999

Christian Mohrenstecher

Mobile +41 76 444 57 93

christian.mohrenstecher@pewatron.com

Sales International Key Accounts

Peter Felder

Phone +41 44 877 35 05
Mobile +41 79 406 49 83

peter.felder@pewatron.com

Sales Other Countries / Product Management

Pressure Sensors

Philipp Kistler
Phone +41 44 877 35 03
philipp.kistler@pewatron.com

Accelerometers / Level Flow sensor elements

Thorsten Ravagni
Phone +49 60 479 53 627
thorsten.ravagni@pewatron.com

Drive technology CH Postcode 5000 – 9999 / DE

Roman Homa
Mobile +41 76 444 00 86
roman.homa@pewatron.com

Gas sensors / Gas sensor modules Load cells

Dr. Thomas Clausen
Phone +41 44 877 35 13
thomas.clausen@pewatron.com

Power supplies

Sebastiano Leggio
Phone +41 44 877 35 06
sebastiano.leggio@pewatron.com

Drive technology CH Postcode 1000 – 4999 / AT / IT / FR

Christian Mohrenstecher
Mobile +41 76 444 57 93
christian.mohrenstecher@pewatron.com

Flow / Level / Medical products

Dr. Adriano Pittarelli
Phone +49 8245 774 95 44
adriano.pittarelli@pewatron.com

Linear position sensors Angle sensors

Eric Letsch
Phone +41 44 877 35 14
eric.letsch@pewatron.com

Current sensors Power solutions

Osman Coban
Phone +49 71 635 363 898
osman.coban@pewatron.com