

Characteristics

Unless otherwise specified, all parameters are measured at 25 °C and 60% RH

Preliminary

Parameters	Min	Typ	Max	Unit
Excitation	5 Vdc @ 5 mA (2.7 - 5.5 Vdc)			
Pressure range	-2.5		2.5	mbar
Resolution ¹			16	Bit
Zero Output (0 mbar)		0		Dec
Full Scale Output (-/+2.5 mabr)	-25600		25600	Dec
Accuracy(25°C)		1.0		%FS, +1LSB
Accuracy(0/50°C) ²		2.5		%FS, +1LSB
Accuracy(-20/70°C) ²		4.5		%FS, +1LSB
Update Rate		1		kHz
Temp - Compensating	-20		70	°C
Temp - Operating	-20		+80	°C
Temp - Storage	-40		+125	°C
Over Pressure	30X			FS
Burst Pressure	60X			FS

NOTES:

1. ENOB = 14 bits
2. Combined accuracy with auto-zero
3. Wetted material contains polyimide, silicon, Au, pyrex, epoxy & FR4
4. Zeroing after installation is recommended
5. The factory setting for I2C slave address is **0x6C** Default

Dimension

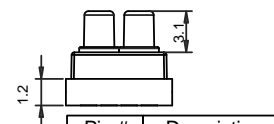
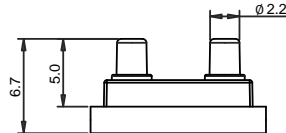
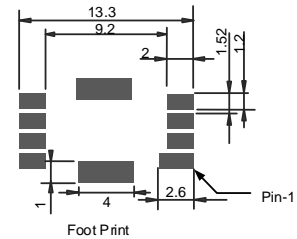
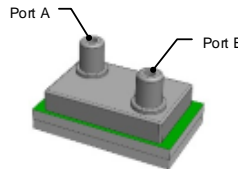
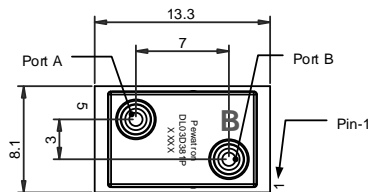

Ordering Information

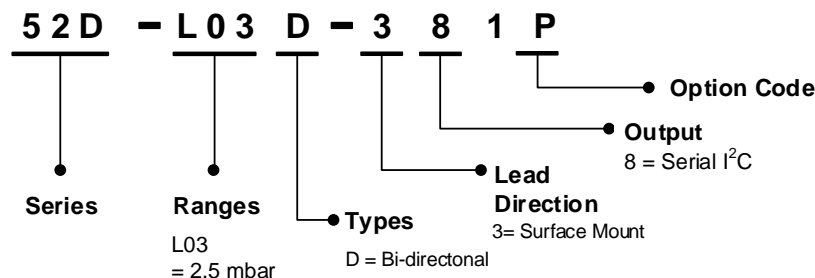

Pin #	Description
1	SDA
2	SCL
3	EOC
4	N.C
5	OUT
6	N.C.
7	VDD
8	GND

Notes:

1. Port B is used for positive differential or gage
2. All dimensions are mm
3. Soldering of lead pins: 250 °C for 5 sec max.
4. N.C. pins must be left floating
5. Pull-up on SCL and SDA is 1KΩ min.
6. A 0.1 uF capacitor must be connected between V_{SS} and V_{DD}, and closing to the sensor

SCD7-311-50010G
03-19 R0

Headquarter Switzerland:
Pewatron AG
Thurgauerstrasse 66
CH-8050 Zurich
Phone +41 44 877 35 00
info@pewatron.com

Office Germany:
Pewatron Deutschland GmbH
Edisonstraße 16
D-85716 Unterschleißheim
Phone +49 89 374 288 87-0
info.de@pewatron.com



PEWATRON
SENSORS · POWER SOLUTIONS

We are here for you. Addresses and Contacts.

Sales Germany & Austria

Postcode 00000 – 31999
Postcode 38000 – 39999
Postcode 80000 – 99999
Austria

Kurt Stritzelberger

Phone +49 89 260 52 80
Mobile +49 171 803 41 35

kurt.stritzelberger@pewatron.com

Postcode 32000 – 37999
Postcode 40000 – 79999

Gerhard Vetter

Phone +49 674 394 75 75
Mobile +49 163 762 74 30

gerhard.vetter@pewatron.com

Geometrical sensors
Sensor elements

Thorsten Ravagni

Phone +49 60 479 53 627

thorsten.ravagni@pewatron.com

Sales Switzerland & Liechtenstein

Postcode 3000 – 9999

Basil Frei

Phone +41 44 877 35 18
Mobile +41 76 279 37 26

basil.frei@pewatron.com

Postcode 1000 – 2999

Christian Mohrenstecher

Mobile +41 76 444 57 93

christian.mohrenstecher@pewatron.com

Sales International Key Accounts

Peter Felder

Phone +41 44 877 35 05
Mobile +41 79 406 49 83

peter.felder@pewatron.com

Sales Other Countries / Product Management

Pressure Sensors

Philipp Kistler
Phone +41 44 877 35 03
philipp.kistler@pewatron.com

Accelerometers / Level Flow sensor elements

Thorsten Ravagni
Phone +49 60 479 53 627
thorsten.ravagni@pewatron.com

Drive technology CH Postcode 5000 – 9999 / DE

Roman Homa
Mobile +41 76 444 00 86
roman.homa@pewatron.com

Gas sensors / Gas sensor modules Load cells

Dr. Thomas Clausen
Phone +41 44 877 35 13
thomas.clausen@pewatron.com

Power supplies

Sebastiano Leggio
Phone +41 44 877 35 06
sebastiano.leggio@pewatron.com

Drive technology CH Postcode 1000 – 4999 / AT / IT / FR

Christian Mohrenstecher
Mobile +41 76 444 57 93
christian.mohrenstecher@pewatron.com

Flow / Level / Medical products

Dr. Adriano Pittarelli
Phone +49 8245 774 95 44
adriano.pittarelli@pewatron.com

Linear position sensors Angle sensors

Eric Letsch
Phone +41 44 877 35 14
eric.letsch@pewatron.com

Current sensors Power solutions

Osman Coban
Phone +49 71 635 363 898
osman.coban@pewatron.com